

OREGON PUBLIC LAND CORNER REPORT / RESTORATION REPORT
Tillamook County Surveyor's Office

BOOK 8 202

SECTION: 7	TOWNSHIP: 1 South	RANGE: 9 West
COUNTY: Tillamook		DATE: 4/18/2024
CORNER DESIGNATION: The Southeast Sixteenth corner of Section 7, Township 1 South, Range 9 West; Willamette Meridian		(Please check one)
		<input checked="" type="checkbox"/> Condition Report Only
		<input type="checkbox"/> Restoration
		<input type="checkbox"/> Rewitness
		<input type="checkbox"/> Unrecorded
		<input type="checkbox"/> Reset at surface
		<input type="checkbox"/> Referenced Out

Previous Rewitnesses, Restorations and Surveys, etc...
B-535 (1967), Rewitness Book 8 page 73 (2017)

History, condition, and sources:

The SE 1/16th corner was first set by Harold Russel RS 707 in 1967 (B-535). He set a 3" Oregon State Board of Forestry brass cap on 1.5-inch galvanized pipe stamped as shown hereon, along with 2 bearing trees and a white painted cedar post. In 2017 (rewitness bk. 8 pg. 73) Terry Jones found the monument in good condition but only the white cedar post remained for a witness marker. He then established 2 new bearing trees. In 2024 the Tillamook County Surveyors Office visited the corner and found the monument to be in good condition up .10' above ground. Listed below are the record accessories for the SE 1/16th corner.

- Found: (Rewitness bk. 8 pg. 73) Rotted white cedar 4"x4" post
- Found: (Rewitness bk. 8 pg. 73) 38" spruce scribed "SE 1/16 57 BT" with a brass nail and washer marked "LS 2507" N30°W 49.20" Now 47" with healed scar and a yellow metal location tag
- Found: (Rewitness bk. 8 pg. 73) 19" hemlock scribed "SE 1/16 57 BT" with brass nail and washer marked "LS 2507" S66°W 29.90' Now a 20" stump the tree snapped off 3' high scribing visible along with the brass nail and washer Marked "LS 2507"
- Found: (unknown origin) orange carsonite post North 1.5'

New accessories set:

The Monument was tied directly using G.P.S. established control. The coordinates have been converted and are provided here in WGS 84, Latitude and Longitude.

Latitude: 45° 29' 45.46"
Longitude: - 123° 49' 43.33"

Pictures of Found Monuments:



Location: ±40' from graveled unused logging road

Tillamook County Surveyor office: 1510 3rd Street Suite C, Tillamook, OR. 97141

Party Chief: Travis Porter, Tillamook County Survey Supervisor

Witnesses: Michael Rice P.L.S. 86926, Tillamook County Surveyor
Kael Pokliuha, Tillamook County Survey Tech

Notes: Digital images taken of monument and accessories.

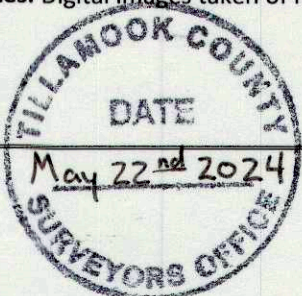

SURVEYOR'S SEAL

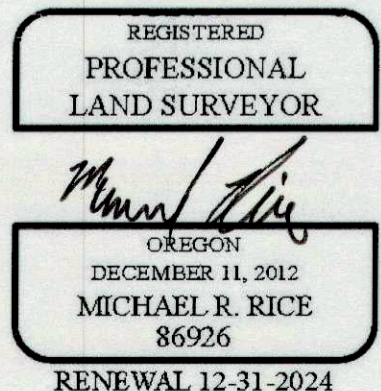

BOOK 8 202